

UCT 200

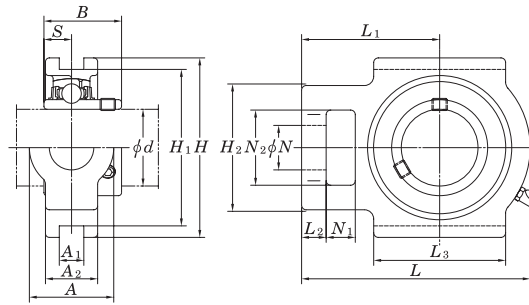

d 12~85mm

Shaft Dia mm	Unit No.	Boundary dimensions mm															Insert No.	Housing No.	Mass kg (approx.)
		N	L ₂	H ₂	N ₂	N	L ₃	A ₁	H ₁	H	L	A	A ₂	L ₁	B	S			
12	UCT 201	16	10	51	32	19	51	12	76	89	94	32	21	61	31.0	12.7	UC 201	T 204	0.79
15	UCT 202	16	10	51	32	19	51	12	76	89	94	32	21	61	31.0	12.7	UC 202	T 204	0.77
17	UCT 203	16	10	51	32	19	51	12	76	89	94	32	21	61	31.0	12.7	UC 203	T 204	0.76
20	UCT 204	16	10	51	32	19	51	12	76	89	94	32	21	61	31.0	12.7	UC 204	T 204	0.74
25	UCT 205	16	10	51	32	19	51	12	76	89	97	32	24	62	34.1	14.3	UC 205	T 205	0.82
30	UCT 206	16	10	56	37	22	57	12	89	102	113	37	28	70	38.1	15.9	UC 206	T 206	1.30
35	UCT 207	16	13	64	37	22	64	12	89	102	129	37	30	78	42.9	17.5	UC 207	T 207	1.60
40	UCT 208	19	16	83	49	29	83	16	102	114	144	49	33	88	49.2	19.0	UC 208	T 208	2.40
45	UCT 209	19	16	83	49	29	83	16	102	117	144	49	35	87	49.2	19.0	UC 209	T 209	2.40
50	UCT 210	19	16	83	49	29	86	16	102	117	149	49	37	90	51.6	19.0	UC 210	T 210	2.50
55	UCT 211	25	19	102	64	35	95	22	130	146	171	64	38	106	55.6	22.2	UC 211	T 211	4.00
60	UCT 212	32	19	102	64	35	102	22	130	146	194	64	42	119	65.1	25.4	UC 212	T 212	5.10
65	UCT 213	32	21	111	70	41	121	26	151	167	224	70	44	137	65.1	25.4	UC 213	T 213	7.00
70	UCT 214	32	21	111	70	41	121	26	151	167	224	70	46	137	74.6	30.2	UC 214	T 214	7.10
75	UCT 215	32	21	111	70	41	121	26	151	167	232	70	48	140	77.8	33.3	UC 215	T 215	7.50
80	UCT 216	32	21	111	70	41	121	26	165	184	235	70	51	140	82.6	33.3	UC 216	T 216	8.50
85	UCT 217	38	29	124	73	48	157	30	173	198	260	73	54	162	85.7	34.1	UC 217	T 217	11.20

Insert Ball Bearings

UC 200

Metric series

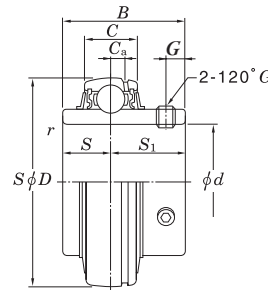

d 12~90mm

Bearing No.	Boundary dimensions mm											Basic load ratings				Mass kg (approx.)
	d	D	B	C	r	S	S ₁	G	d _s	C _a	d ₄	dynamic kN	static kN	dynamic kgf	static kgf	
UC201	12	47	31.0	17	1.0	12.7	18.3	4.5	M6X0.75	4.5	29.0	12.8	6.6	1,300	670	0.21
UC202	15	47	31.0	17	1.0	12.7	18.3	4.5	M6X0.75	4.5	29.0	12.8	6.6	1,300	670	0.19
UC203	17	47	31.0	17	1.0	12.7	18.3	4.5	M6X0.75	4.5	29.0	12.8	6.6	1,300	670	0.18
UC204	20	47	31.0	17	1.5	12.7	18.3	4.5	M6X0.75	4.5	29.0	12.8	6.6	1,300	670	0.16
UC205	25	52	34.1	17	1.5	14.3	19.8	5.0	M6X0.75	4.5	34.0	14.0	7.9	1,420	800	0.19
UC206	30	62	38.1	19	1.5	15.9	22.2	5.0	M6X0.75	5.1	40.5	19.6	11.3	2,000	1,150	0.31
UC207	35	72	42.9	20	2.0	17.5	25.4	6.0	M8X1	5.8	48.0	25.9	15.4	2,640	1,550	0.48
UC208	40	80	49.2	21	2.0	19.0	30.2	8.0	M8X1	6.2	53.0	29.3	17.9	2,980	1,820	0.62
UC209	45	85	49.2	22	2.0	19.0	30.2	8.0	M8X1	6.5	57.3	33.0	20.5	3,350	2,090	0.67
UC210	50	90	51.6	23	2.0	19.0	32.6	9.0	M10X1.25	6.5	63.0	35.5	23.2	3,600	2,360	0.78
UC211	55	100	55.6	24	2.5	22.2	33.4	9.0	M10X1.25	7.3	70.0	43.0	29.4	4,350	3,000	1.03
UC212	60	110	65.1	26	2.5	25.4	39.7	10.0	M10X1.25	7.7	77.0	52.5	36.1	5,350	3,680	1.45
UC213	65	120	65.1	27	2.5	25.4	39.7	10.0	M10X1.25	8.3	82.1	57.5	40.0	5,850	4,080	1.71
UC214	70	125	74.6	29	2.5	30.2	44.4	12.0	M12X1.5	8.7	87.0	62.0	44.0	6,300	4,480	2.06
UC215	75	130	77.8	30	2.5	33.3	44.5	14.0	M12X1.5	9.2	91.5	66.0	48.2	6,700	4,910	2.22
UC216	80	140	82.6	32	3.0	33.3	49.3	14.0	M12X1.5	9.6	98.5	72.5	53.0	7,400	5,400	2.82
UC217	85	150	85.7	34	3.0	34.1	51.6	14.0	M12X1.5	10.5	105.0	83.5	61.8	8,500	6,300	3.38
UC218	90	160	96.0	36	3.0	39.7	56.3	15.0	M12X1.5	11.1	111.5	95.5	71.4	9,750	7,280	4.34

Insert Ball Bearings



UC 200

Inch series

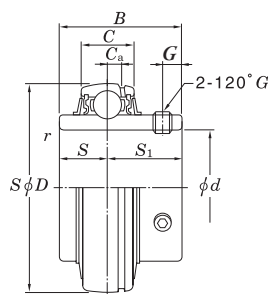

d $1/2 \sim 3 1/2$ inch

Bearing No.	Shaft dia inch	Boundary dimensions mm								Basic load ratings				Mass kg (approx.)		
		d	D	B	C	r	S	S_1	G	$d_s(UNF)$	C_a	d_4	C_r kN		C_{or} static	C_r dynamic
UC202-8	1/2	1.8504	1.2200	0.6690	0.0390	0.5000	0.7200	0.1770	1/4-28	0.1770	1.1420	12.8	6.6	1,300	670	0.21
UC202-10	5/8	1.8504	1.2200	0.6690	0.0390	0.5000	0.7200	0.1770	1/4-28	0.1770	1.1420	12.8	6.6	1,300	670	0.19
UC203-11	11/16	1.8504	1.2200	0.6690	0.0390	0.5000	0.7200	0.1770	1/4-28	0.1770	1.1420	12.8	6.6	1,300	670	0.18
UC204-12	3/4	1.8504	1.2200	0.6690	0.0590	0.5000	0.7200	0.1770	1/4-28	0.1770	1.1420	12.8	6.6	1,300	670	0.16
UC205-14	7/8	2.0472	1.3420	0.6690	0.0590	0.5630	0.7800	0.1970	1/4-28	0.1770	1.3390	14.0	7.9	1,420	800	0.19
UC205-16	1	2.0472	1.3420	0.6690	0.0590	0.5630	0.7800	0.1970	1/4-28	0.1770	1.3390	14.0	7.9	1,420	800	0.19
UC206-18	1 1/8	2.4409	1.5000	0.7480	0.0590	0.6260	0.8740	0.1970	1/4-28	0.2010	1.5940	19.6	11.3	2,000	1,150	0.31
UC206-19	1 3/16	2.4409	1.5000	0.7480	0.0590	0.6260	0.8740	0.1970	1/4-28	0.2010	1.5940	19.6	11.3	2,000	1,150	0.31
UC207-20	1 1/4	2.8346	1.6890	0.7870	0.0790	0.6890	1.0000	0.2360	5/16-24	0.2280	1.8900	25.9	15.4	2,640	1,550	0.48
UC207-21	1 5/16	2.8346	1.6890	0.7870	0.0790	0.6890	1.0000	0.2360	5/16-24	0.2280	1.8900	25.9	15.4	2,640	1,550	0.48
UC207-22	1 3/8	2.8346	1.6890	0.7870	0.0790	0.6890	1.0000	0.2360	5/16-24	0.2280	1.8900	25.9	15.4	2,640	1,550	0.48
UC207-23	1 7/16	2.8346	1.6890	0.7870	0.0790	0.6890	1.0000	0.2360	5/16-24	0.2280	1.8900	25.9	15.4	2,640	1,550	0.48
UC208-24	1 1/2	3.1496	1.9370	0.8270	0.0790	0.7480	1.1890	0.3150	5/16-24	0.2440	2.0870	29.3	17.9	2,980	1,820	0.62
UC209-26	1 5/8	3.3465	1.9370	0.8660	0.0790	0.7480	1.1890	0.3150	5/16-24	0.2560	2.2560	33.0	20.5	3,350	2,090	0.67
UC209-27	1 11/16	3.3465	1.9370	0.8660	0.0790	0.7480	1.1890	0.3150	5/16-24	0.2560	2.2560	33.0	20.5	3,350	2,090	0.67
UC209-28	1 3/4	3.3465	1.9370	0.8660	0.0790	0.7480	1.1890	0.3150	5/16-24	0.2560	2.2560	33.0	20.5	3,350	2,090	0.67
UC210-30	1 7/8	3.5433	2.0310	0.9060	0.0790	0.7480	1.2830	0.3540	3/8-24	0.2560	2.4800	35.5	23.2	3,600	2,360	0.78
UC210-31	1 15/16	3.5433	2.0310	0.9060	0.0790	0.7480	1.2830	0.3540	3/8-24	0.2560	2.4800	35.5	23.2	3,600	2,360	0.78
UC211-32	2	3.9370	2.1890	0.9450	0.0980	0.8740	1.3150	0.3540	3/8-24	0.2870	2.7560	43.0	29.4	4,350	3,000	1.03
UC211-35	2 3/16	3.9370	2.1890	0.9450	0.0980	0.8740	1.3150	0.3540	3/8-24	0.2870	2.7560	43.0	29.4	4,350	3,000	1.03
UC212-36	2 1/4	4.3307	2.5630	1.0240	0.0980	1.0000	1.5630	0.3940	3/8-24	0.3030	3.0310	52.5	36.1	5,350	3,680	1.45
UC212-38	2 3/8	4.3307	2.5630	1.0240	0.0980	1.0000	1.5630	0.3940	3/8-24	0.3030	3.0310	52.5	36.1	5,350	3,680	1.45
UC212-39	2 7/16	4.3307	2.5630	1.0240	0.0980	1.0000	1.5630	0.3940	3/8-24	0.3030	3.0310	52.5	36.1	5,350	3,680	1.45
UC213-40	2 1/2	4.7244	2.5630	1.0630	0.0980	1.0000	1.5630	0.3940	3/8-24	0.3270	3.2320	57.5	40.0	5,850	4,080	1.71
UC214-44	2 3/4	4.9213	2.9370	1.1420	0.0980	1.1890	1.7480	0.4720	7/16-20	0.3430	3.4250	62.0	44.0	6,300	4,480	2.06
UC215-48	3	5.1181	3.0630	1.1810	0.0980	1.3110	1.7520	0.5510	7/16-20	0.3620	3.6020	66.0	48.2	6,700	4,910	2.22
UC216-50	3 1/8	5.5118	3.2520	1.2600	0.1180	1.3110	1.9410	0.5510	7/16-20	0.3780	3.8780	72.5	53.0	7,400	5,400	2.82
UC217-52	3 1/4	5.9055	3.3740	1.3390	0.1180	1.3430	2.0310	0.5510	7/16-20	0.4130	4.1340	83.5	61.8	8,500	6,300	3.38
UC218-56	3 1/2	6.2992	3.7800	1.4170	0.1180	1.5630	2.2170	0.5910	1/2-20	0.4370	4.3900	95.5	71.4	9,750	7,280	4.34